

PRODUCT SPECIFICATION

Harmsco® Model #: HUR 1X170FL

Description: Tangential Entry, Up-Flow Cartridge Filter Housing with Swing Bolt Closure and Flanged Connections.

Details:

1. Stainless steel construction, all wetted metallic components are ASTM A-240.
2. Swing bolt style housing closure. Swing bolts are ASTM A-193 B8.
3. NSF Certified using Genuine Harmsco® Hurricane® replacement filter cartridges.*
4. Tangential inlet and the integral inner-can, create a centrifugal flow that induces pre-filtration by heavy particulate separation.
5. Patented "Up-Flow" design that;
 - a. Self purges housing of air.
 - b. Eliminates by-pass contamination during servicing.
 - c. Improves efficiency by creating an even flow distribution across filtering media.
6. Strong, durable construction.
7. Utilizes one (1) Genuine Harmsco® Hurricane® HC/170 filter cartridge, available in many micron ratings. *
Note: Harmsco® Hurricane® HC/170 filter cartridges available include: Activated Carbon, High Temperature, SureSafe™, Poly-Mesh, Poly-Pleat™ & more. **
8. Inlet & Outlet are NPS 2 Flanges ANSI/ASME B16.5 Class 150
9. Drains (Qty 2) are ¾" Female NPT (FPT) Couplings, Class 1000
10. Vent is ¼" Female NPT (FPT) Coupling, Class 1000
11. Gauge Port (Qty 1, Inlet) is ¼" Female NPT (FPT) Coupling, Class 1000
12. Closure Gasket is EPDM 70 Durometer O-ring.
13. Electro-polish finish.
14. Pressure Rating - 150 P.S.I.G.
15. Temperature Rating – Up to 140°F
Note: Higher temperatures are possible, check cartridge specifications. **
16. Flow Rate – 150 GPM Maximum. See Pressure Drop vs. Flow Rate Curve, page 2.
17. One person can perform maintenance.

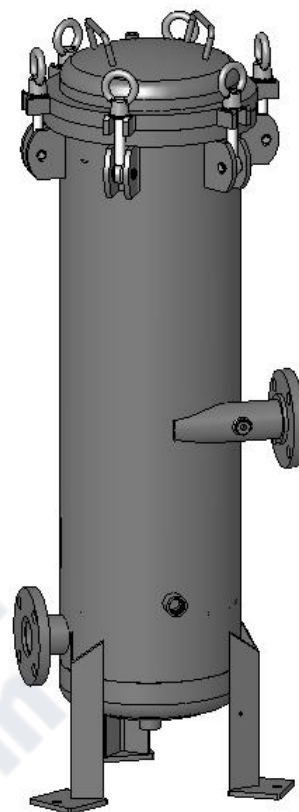

Requirements:

Floor Load:	Dry weight = 150 lbs. Volume = 16 US gallons x 8.337 lbs./US gallon (water) = 134 lbs. Total weight = 150 + 134 = 284 lbs. (housing + water) Floor contact area = .1875 ft ² . Floor Load = 284 lbs. divided by .1875 ft ² = 1,515 pounds per square foot (approx.) Note: Piping shall conform to all applicable codes and be independently supported. If floor strength is suspect, use appropriate measures to adequately distribute load.
Floor Space:	1.6 ft ² , See Installation Diagram, page 3.
Service Height:	77", See Installation Diagram, page 3.
Bonding:	Housing shall be bonded in accordance with all applicable codes. A grounding lug is provided.

Recommended Spare Parts:

Closure Gasket O-ring: PN 361-E
Harmsco® Hurricane® HC/170 replacement cartridge.

* The use of any filter cartridge other than a Genuine Harmsco® Hurricane® filter cartridge in this filter housing voids certifications by NSF International.

** Contact a Harmsco® sales representative for Harmsco® Hurricane® HC/170 filter cartridge specifications.

This product is manufactured under one or more of the following patents: U.S. NO. 4,187,179; 3,720,322; CANADA NO. 977,693; GT. BRIT. NO. 1,372,014; W. GERMANY NO. 2,261,817; FRANCE NO. 7,246,864; EUROPEAN NO. 0,191,844, Other patents pending.

Notice: The information contained in this publication is considered accurate, and is intended to be used as a guide. This information is subject to change without notification. Contact Harmsco® Filtration Products for the latest, most up to date, specifications. Harmsco® Filtration Products does not assume any liability for the accuracy and completeness of the data in this publication. Temperature ratings, flow rates and chemical resistance can be affected by a number of unknown factors. End users should perform their own tests to determine suitability for each application.

Pressure Drop vs. Flow Rate Curve

Harmsco® HUR 1X170FL
Hurricane® HC/170-20 Cartridge
Qty 1; with clean water.

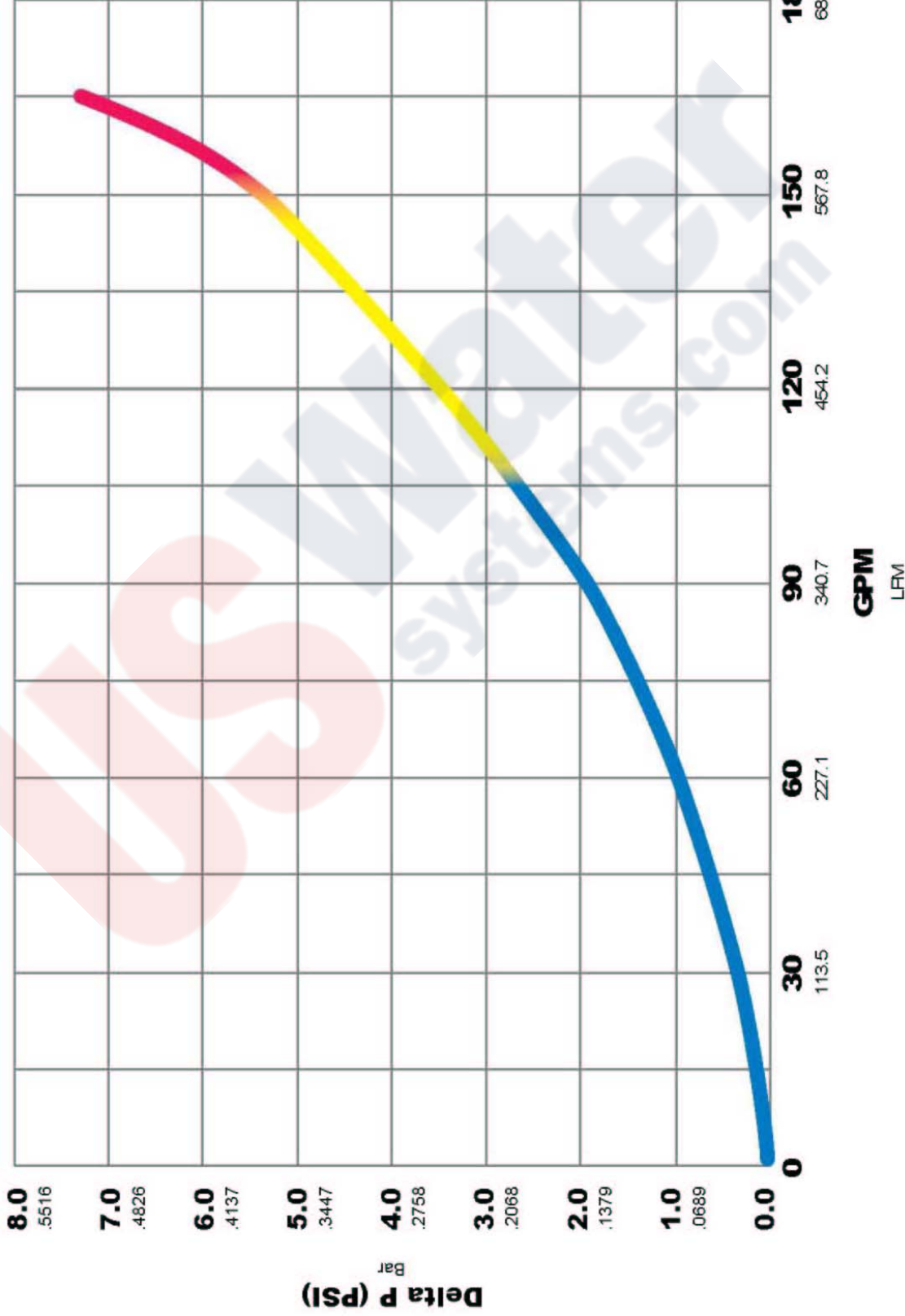

■ Most Favorable
■ Favorable
■ Least Favorable

Max. Flow Rate -
 150 GPM
 Recommended Flow Rate -
 105 GPM

www.harmsco.com
sales@harmsco.com
 800-327-3248
 561-848-9628



Harmsco® Filtration Products Installation Diagram Hurricane® 1 X 170 Swing Bolt Housing

